



# R315 Series 8 in 1 Multi-sensor Device

Smart and Powerful  
Create Possibilities in One Hand.

## R315 series is now 8 in 1



Main Product Configurations

Light + PIR



Emergency Button + PIR



+

External Sensor

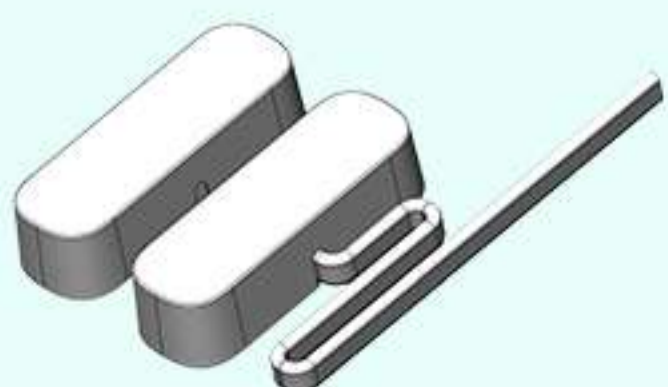

Reed switch

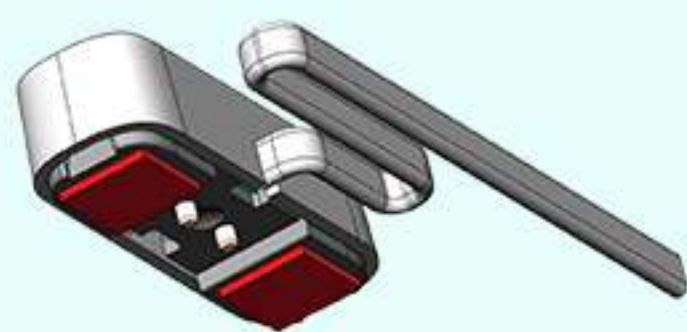

Water leak



Dry Contact IN  
DO Out

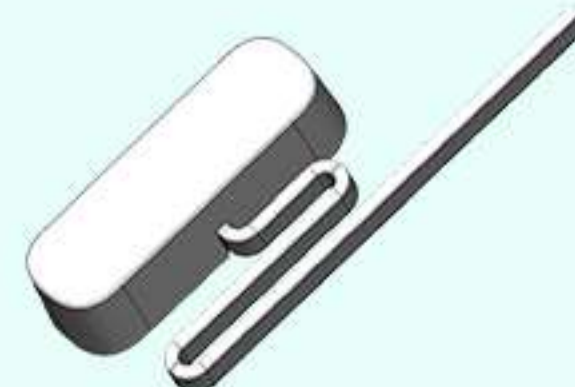

External Vibration

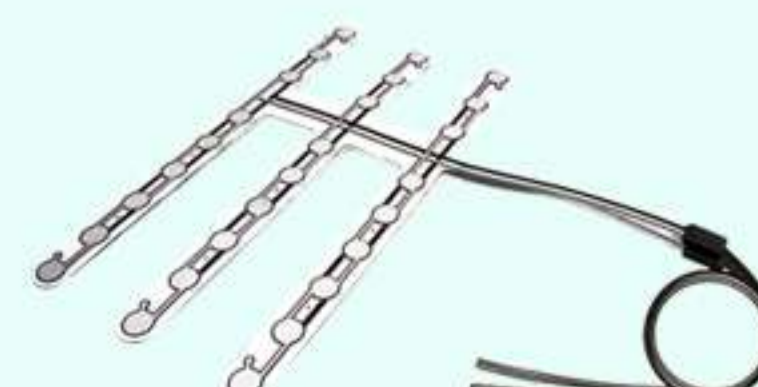

Seat Occupancy



Glass Break

# 8 in 1 Body Appearance

Each main body is equipped with 5 built-in sensors.



- Temperature & Humidity
- Light
- Built - in Vibration
- PIR
- Emergency button
- Tilt

- Temperature & Humidity
- Light
- Built - in Vibration
- PIR
- Emergency button
- Tilt

## R315 External Sensors

### External Sensor Options

- Reed switch
- Water leak
- Dry contact IN
- DO OUT
- External vibration
- Seat occupancy
- Glass break

3 Connectors

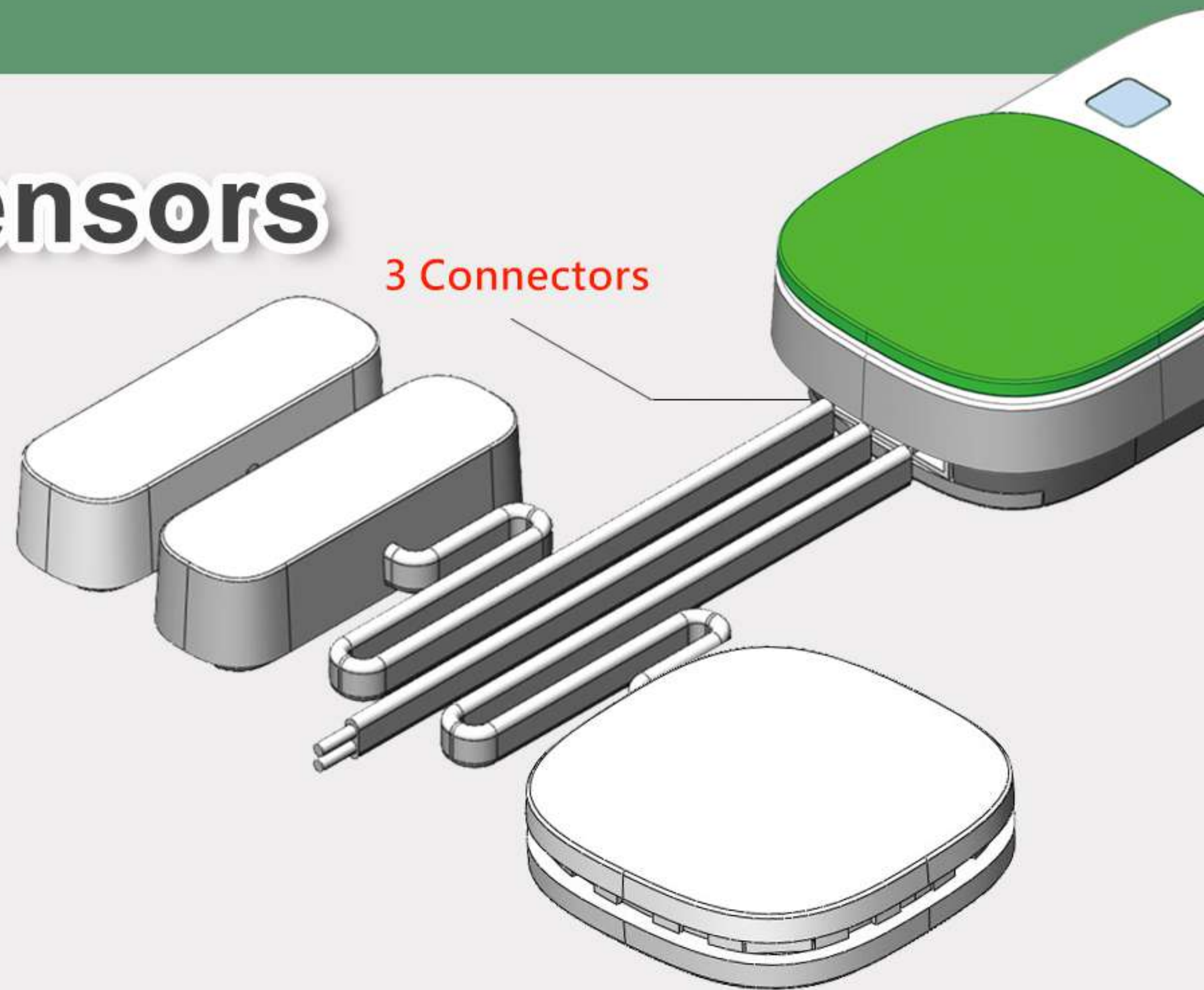

◆ Connect 3 out of 7 external sensors

◆ Positions of external sensors could not be changed due to the interior electrical system.

Reed switch

Water leak

Dry contact IN  
DO OUT

External vibration

Seat occupancy

Glass break

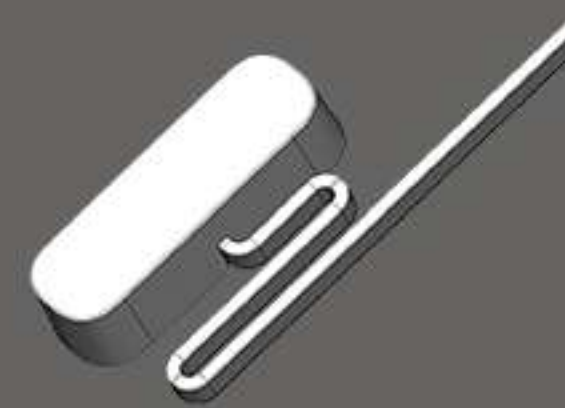
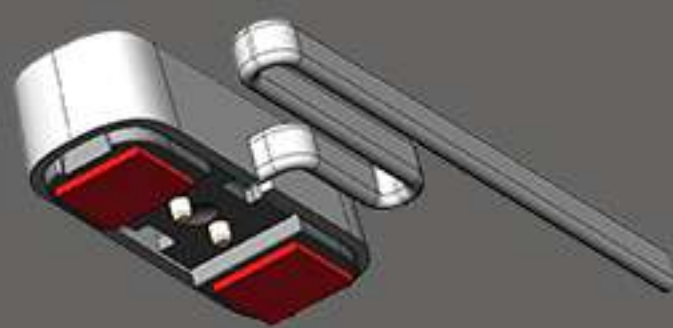
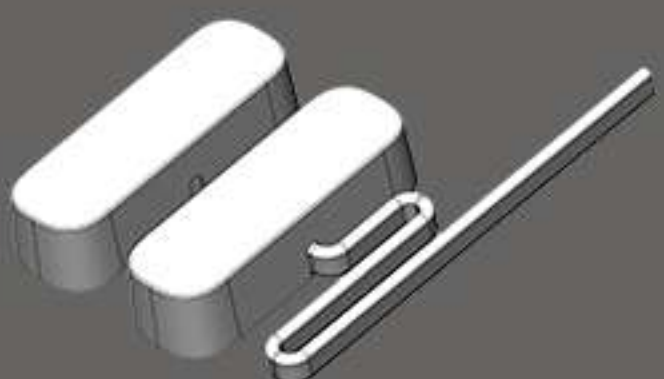

# Application scenario

## Security and Alarm System

Improve security, prevent potential risk of break-ins



### R31527

- Temperature & Humidity
- PIR
- Light
- Tilt
- Vibration
- Reed Switch \* 2
- Glass Break



### R31597

- Temperature & Humidity
- PIR
- Push Button
- Tilt
- Vibration
- Reed Switch
- Glass Break \* 2



### R315102

- Temperature & Humidity
- PIR
- Light
- Tilt
- Vibration
- Reed Switch
- Glass Break \* 2

**For residential houses, stores, hotels, and warehouses:**



#### Vibration Sensor:

Safes and showcases vibration detection.



#### Reed Switch:

Showcase and safe door using monitoring.



#### Glass Break:

Glass break detection for showcases.



#### PIR:

Motion detection in exclusive sections for valuable goods.



## Disaster Prevention

Minimize the damage that natural disasters caused

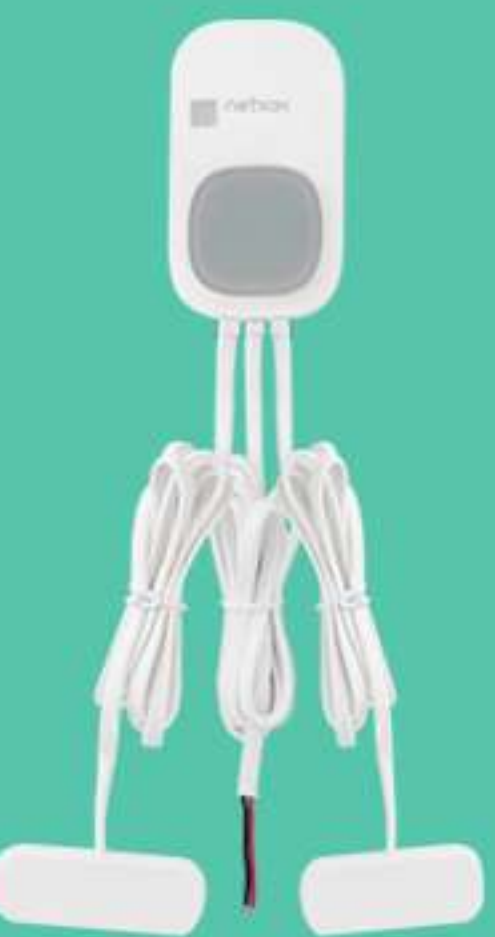

### R31521

- Temperature & Humidity
- PIR
- Light
- Tilt
- Vibration
- Water Leak \* 2
- Digital Output



### R31559

- Temperature & Humidity
- PIR
- Push Button
- Tilt
- Vibration
- Water Leak \* 2
- Digital Output



### R31513

- Temperature & Humidity
- PIR
- Tilt
- Push Button
- Vibration
- Water Leak
- Reed Switch
- External Vibration

**For warehouses, server rooms, and wine cellars:**



#### Temperature and humidity:

Ambient temperature and humidity detection.



#### Water Leak:

Water leaking detection.



#### Tilt:

Tilted shelves detection.



#### Vibration Sensor:

Shelves and wine cabinets vibration detection.



# Medical Alert System

Provide a comprehensive support

## R31504

- Temperature & Humidity
- PIR
- Push Button
- Reed Switch
- Seat occupancy

## R31535

- Temperature & Humidity
- PIR
- Push Button
- Vibration
- Reed Switch
- Digital Output
- Glass Break
- Tilt

## R31594

- Temperature & Humidity
- PIR
- Push Button
- Vibration
- Water Leak
- Reed Switch
- Dry Connect In
- Tilt

### For hospitals and nursing homes:



#### Push Button:

Receiving medical alerts from patients and seniors.



#### PIR:

Motion detection.



#### Reed Switch:

Doors and windows using monitoring.



#### Seat occupancy:

Patients and seniors condition detection (such as sitting too long or falling from chairs)

# Other Customizing Options

Create better customer experiences

## R31531

- Temperature & Humidity
- PIR
- Light
- Vibration
- Reed Switch
- Dry Connect In
- Digital Output
- Tilt

## R31538

- Temperature & Humidity
- PIR
- Push Button
- Vibration
- Reed Switch
- Dry Connect In
- Digital Output
- Tilt

## R31561

- Temperature & Humidity
- PIR
- Light
- Vibration
- Reed Switch
- Digital Output
- Glass Break
- Tilt

### For smart hotels:



#### Temperature and humidity:

Ambient temperature and humidity detection.



#### PIR:

Motion detection to control the light switches.



#### Dry Connect:

Connect with switch panel, SOS button, door magnet, infrared detection, and electric key card switch.

#### Digital Output:

Connect with other devices or buttons to trigger indicators and bells.

